

WANDHAKEN STABFORM MIT SCHMALEM KOPF

DESIGN-ÜBERSICHT

Maßstab 1:2

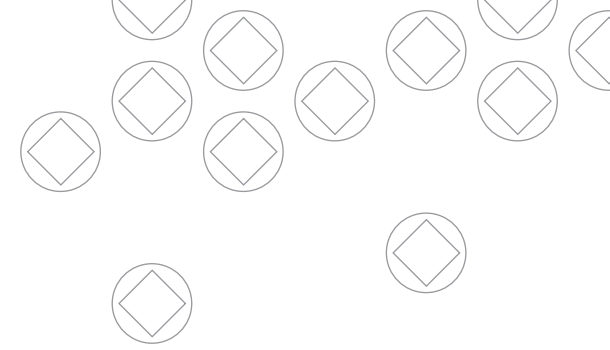

HSF1-K
zur Verschraubung
Ø12 mm, Länge 37 mm

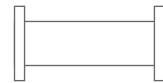

HSF1-K-R20
zur Verschraubung
Ø12 mm, Länge 40 mm

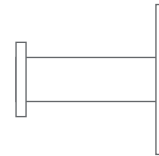

HSF1-K-R40
zur Verschraubung
Ø12 mm, Länge 40 mm

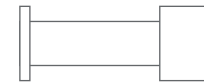

HSF1-K-WS
zur Verschraubung
Ø12 mm, Länge 52 mm

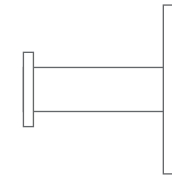

HSF1-K-K45
zur Verklebung
Ø12 mm, Länge 43 mm

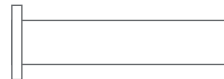

HSF1-L
zur Verschraubung
Ø12 mm, Länge 57 mm

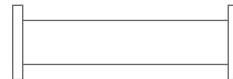

HSF1-L-R20
zur Verschraubung
Ø12 mm, Länge 60 mm

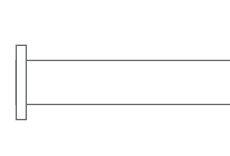

HSF1-L-R40
zur Verschraubung
Ø12 mm, Länge 60 mm

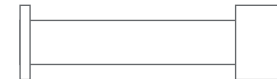

HSF1-L-WS
zur Verschraubung
Ø12 mm, Länge 72 mm



HSF1-L-K45
zur Verklebung
Ø12 mm, Länge 63 mm