

DR700HW MONTAGEANLEITUNG

Telefon: +49 721 530 772 0

Fax: +49 721 530 772 22

E-Mail: phos@phos.de

PHOS Design GmbH

Wertstraße 12

76189 Karlsruhe

www.phos.de

PHOS
Edelstahl Design

1 Positionen der Bohrungen an der Wand

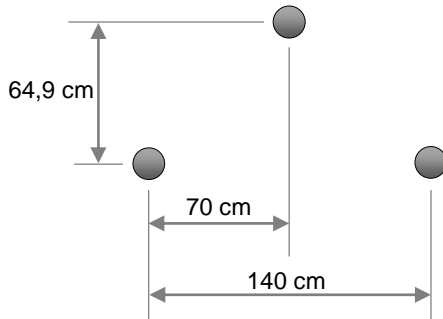

2 Für alle 3 Bohrungen gilt

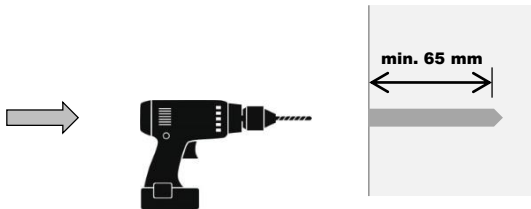

 **Ø8 mm**

3 Dübel für alle 3 Bohrungen

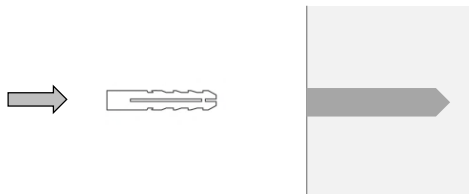

3 Für das obere Wandlager (Montageprinzip einer Stockschraube)

3a

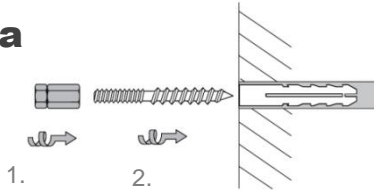

3b

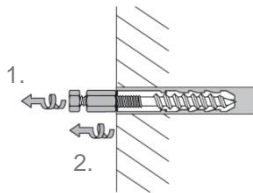

3c

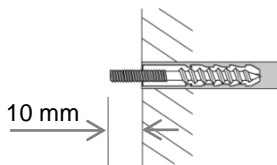

4 Wandlager

1x (oben)

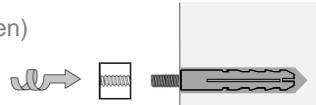

2x (links und rechts)

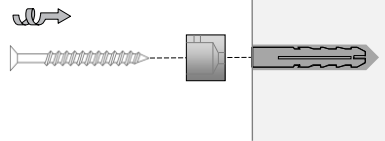

5 Wandlager oben

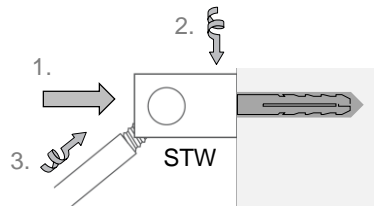

- 1.) STW auf den Adapter an der Wand stecken
- 2.) Fixierungsschraube fest drehen
- 3) Zwischenträger eindrehen

6 Montage der Duschvorhangstange

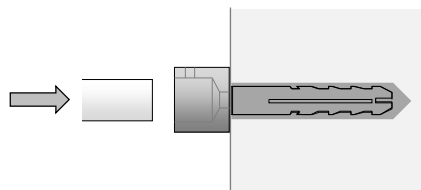

Wichtig: Das **Sackloch** am vorderen Scheitelpunkt der Stange muss **nach unten** zeigen.

7 Endmontage

