



## **DSN12-1600DW MONTAGEANLEITUNG**

Telefon: +49 721 530 772 0

Fax: +49 721 530 772 22

E-Mail: [phos@phos.de](mailto:phos@phos.de)

PHOS Design GmbH

Wertstraße 12

76189 Karlsruhe

[www.phos.de](http://www.phos.de)

# 1

2 Bohrungen vornehmen (Achtung! Die Skizzen sind nicht maßstabsgetreu!)

## Vorderansicht:

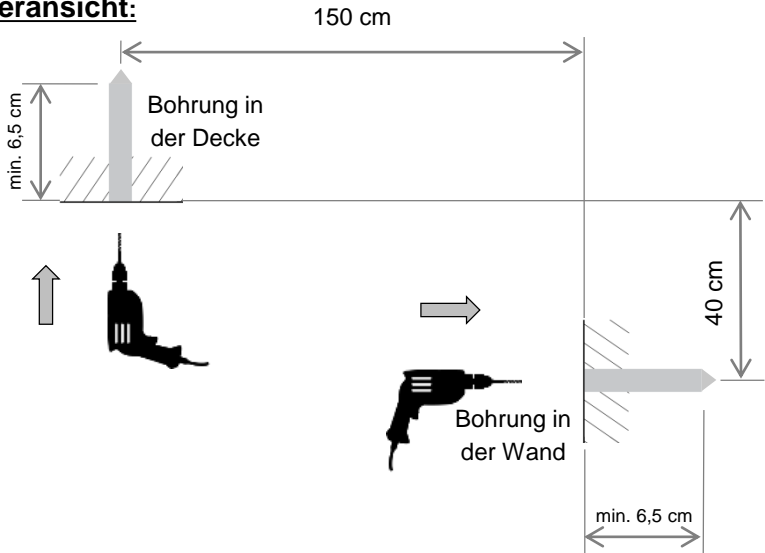

## Seitenansicht:

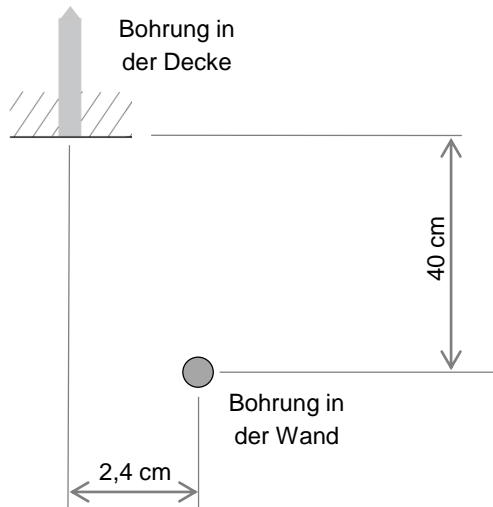

## 2 Dübel

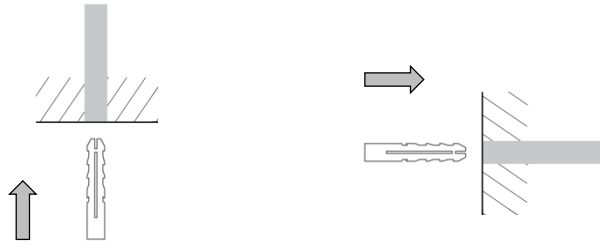

## 3 Stockschrauben-Montage in der Decke

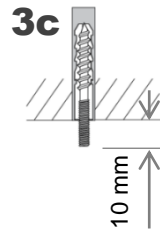
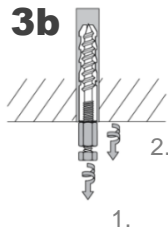
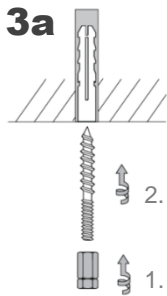

## 4 Deckenträgermontage

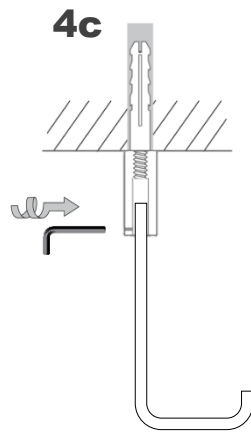
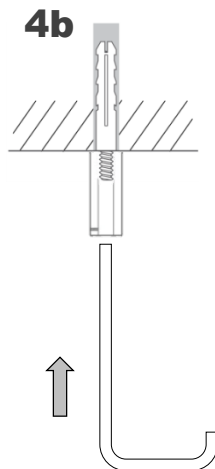
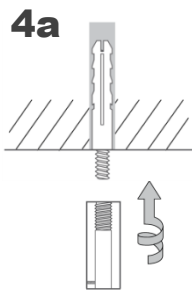

## 5 Wandlager-Montage

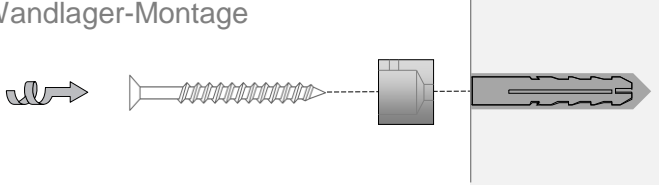

## 6 Duschvorhangstange ins Wandlager einführen

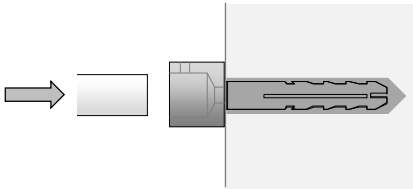

**Wichtig:** Das **Sackloch** am vorderen Ende der Stange muss **nach unten** zeigen.

## 7 Finale Montage der Duschvorhangstange

