



DSN12-1600DW MONTAGEANLEITUNG

Telefon: +49 721 530 772 0

Fax: +49 721 530 772 22

E-Mail: phos@phos.de

PHOS Design GmbH

Wertstraße 12

76189 Karlsruhe

www.phos.de

1

2 Bohrungen vornehmen (Achtung! Die Skizzen sind nicht maßstabsgetreu!)

Vorderansicht:

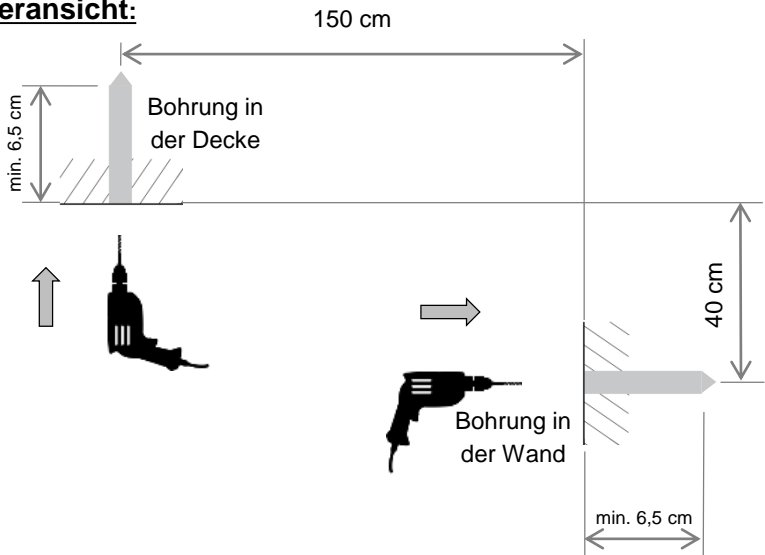

Seitenansicht:

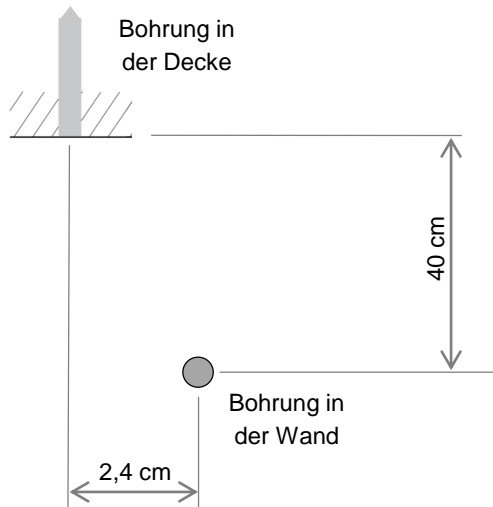

2 Dübel

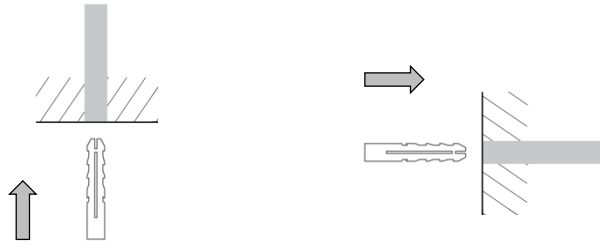

3 Stockschrauben-Montage in der Decke

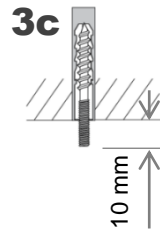
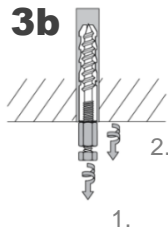
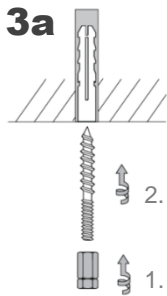

4 Deckenträgermontage

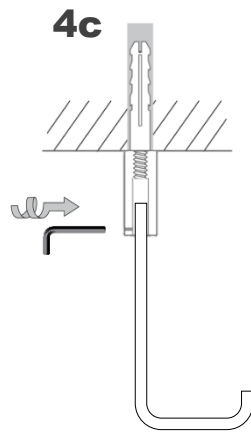
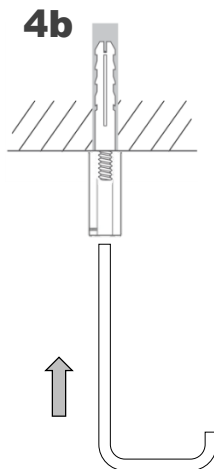
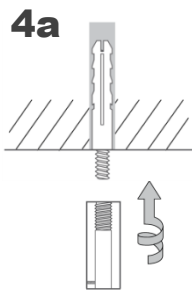

5 Wandlager-Montage

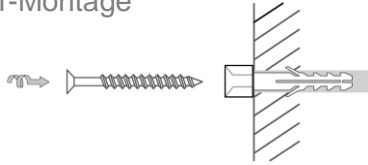

6 Montage der Duschstange

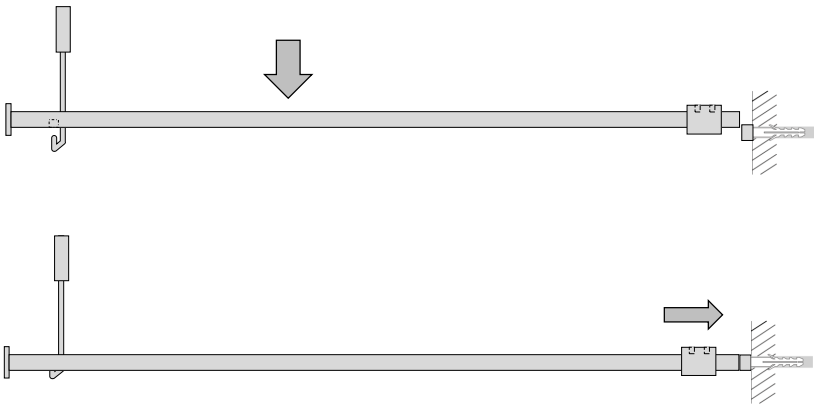

7 Fixierungsschrauben festziehen

