







- 2 x 
- 1 x 
- 1 x 
- 2 x 
- 2 x 
- 2 x 
- 1 x 
- 1 x 
- 14 x 
- 4 x 
- 4 x 
- 1 x 

- 1**
- 8 x 
  - 1 x 
  - 2 x 
  - 1 x 
  - 1 x 
  - 2 x 
  - 2 x 

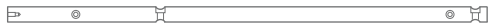
Linke Tischgestellseite:

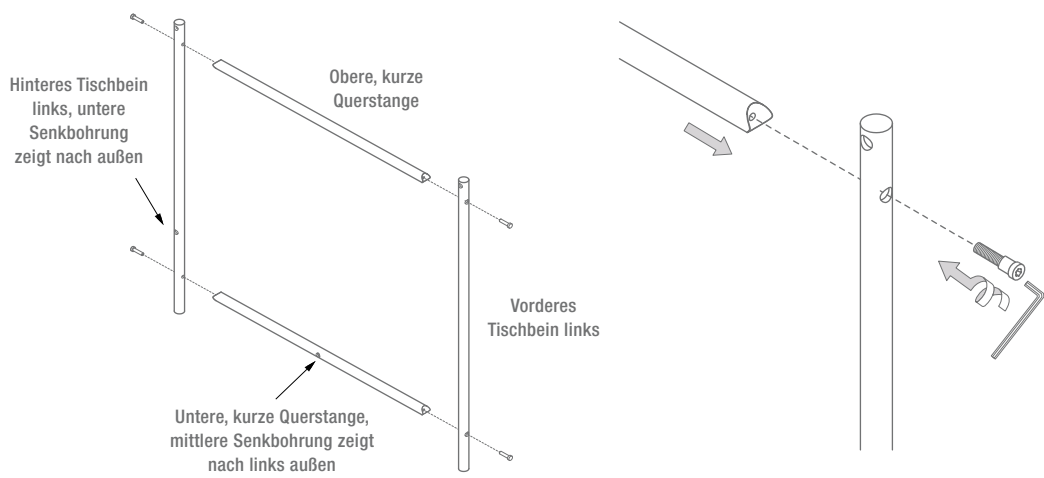

- 2 2 x  1 x  2 x 

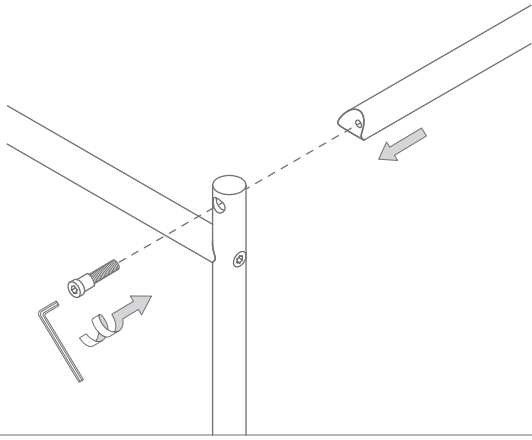

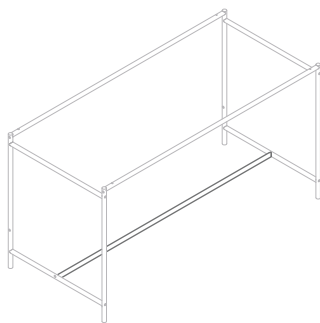

- 3 2 x  1 x  1 x 

Montage als Esstisch:

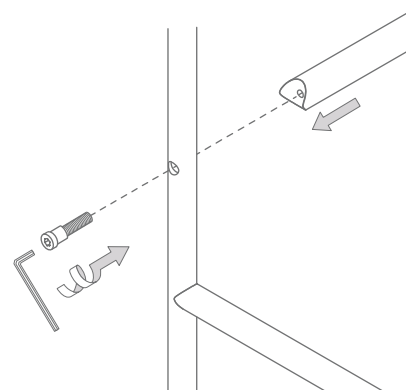
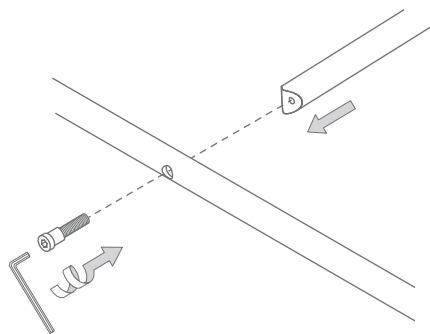
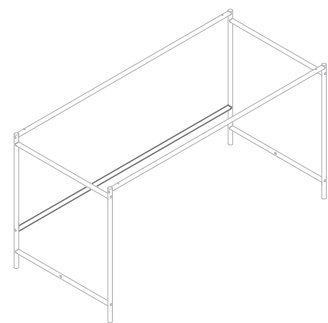

Montage als Schreibtisch:



4 4 x  1 x 

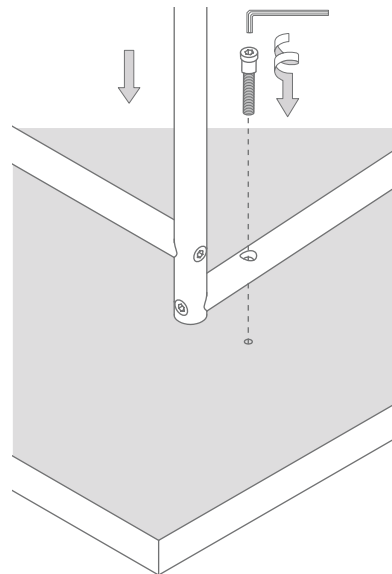
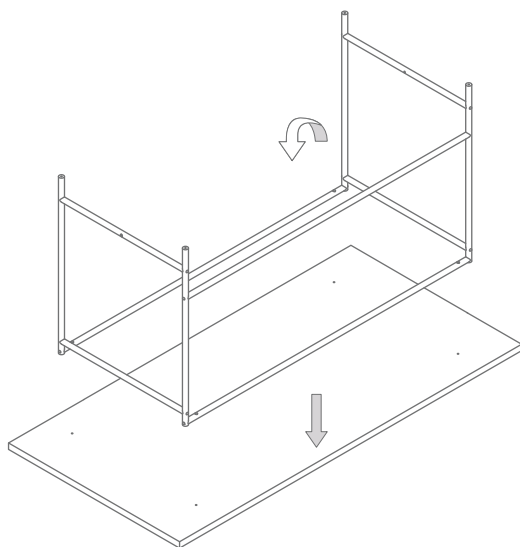

5 4 x 

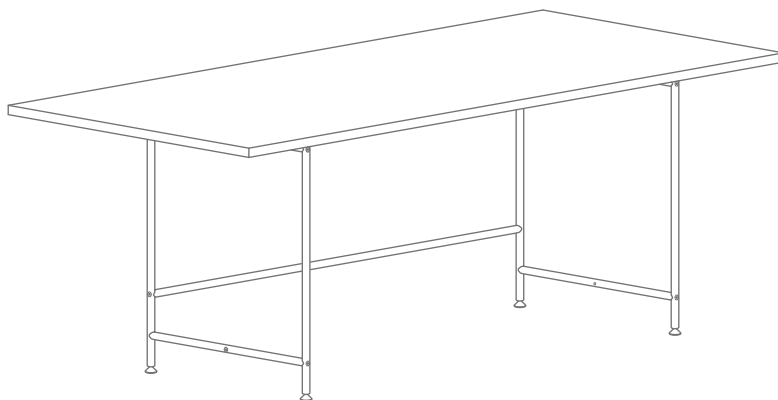
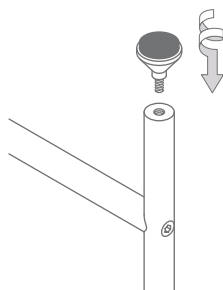

PHOS Design und PHOS Produkte sind durch Marken- und Urheberrecht geschützt. Unsere Montageanleitungen beziehen sich auf unsere Serienprodukte. Sollten Sie ein individuelles PHOS-Produkt bestellt haben, können die Angaben, wie z. B. Vermaßungen, abweichen. Bei Fragen hierzu kontaktieren Sie uns bitte gerne – per Telefon + 49 721 530772-0 oder per E-Mail phos@phos.de.

**EINE AUSFÜHRLICHE MONTAGEANLEITUNG ERHALTEN SIE MIT DER LIEFERUNG.**

© PHOS Design GmbH, Karlsruhe, 2023